

Telescopic hanger bar

The telescopic hangerbar (1) can be adjusted into three widths.

Make sure that you are always using the prescribed width of the hangerbar and that the hooks always are in the same position on both sides.

Adjust the width like this:

1. Grab the hook on the side of the hangerbar (2) and turn the hook 90 ° to the side.
2. At the same time pull the hooks out or push them in depending on if you want to make the hangerbar wider or more narrow. The hangerbar will then adjust the width by following a track in the metal part.
3. By turning the hooks 90 ° in the opposite direction again the hooks will turn into their correct position.
4. Make sure that the number 1, 2 or 3 on the metal part is fully visible and that the hook is facing the correct direction (3).

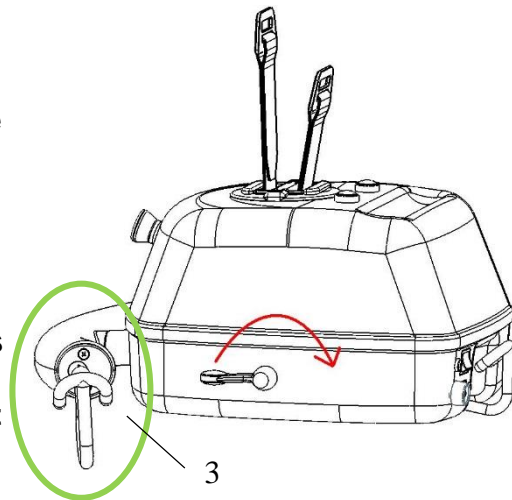
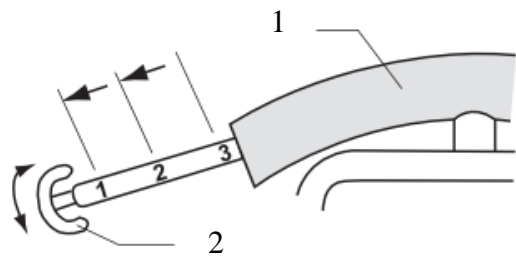
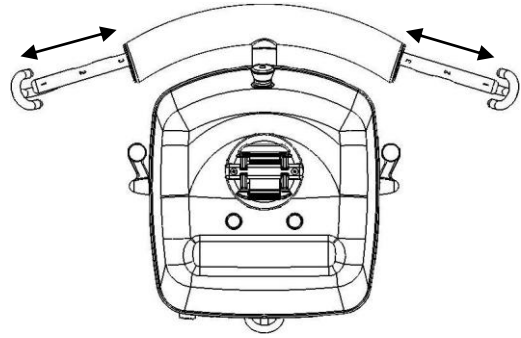

Ensure that you are attaching the sling to the hangerbar correctly and that the sling is fully anchored in the hooks. When operating the lift upwards ensure again that the sling is correctly attached to the hangerbar and the hooks are in the correct position.

Do not perform lift or attach sling if the hanger bar is not in the straight up / down position with both sides in the same # setting or if the hanger bar does not lock into position settings.